

Section II.

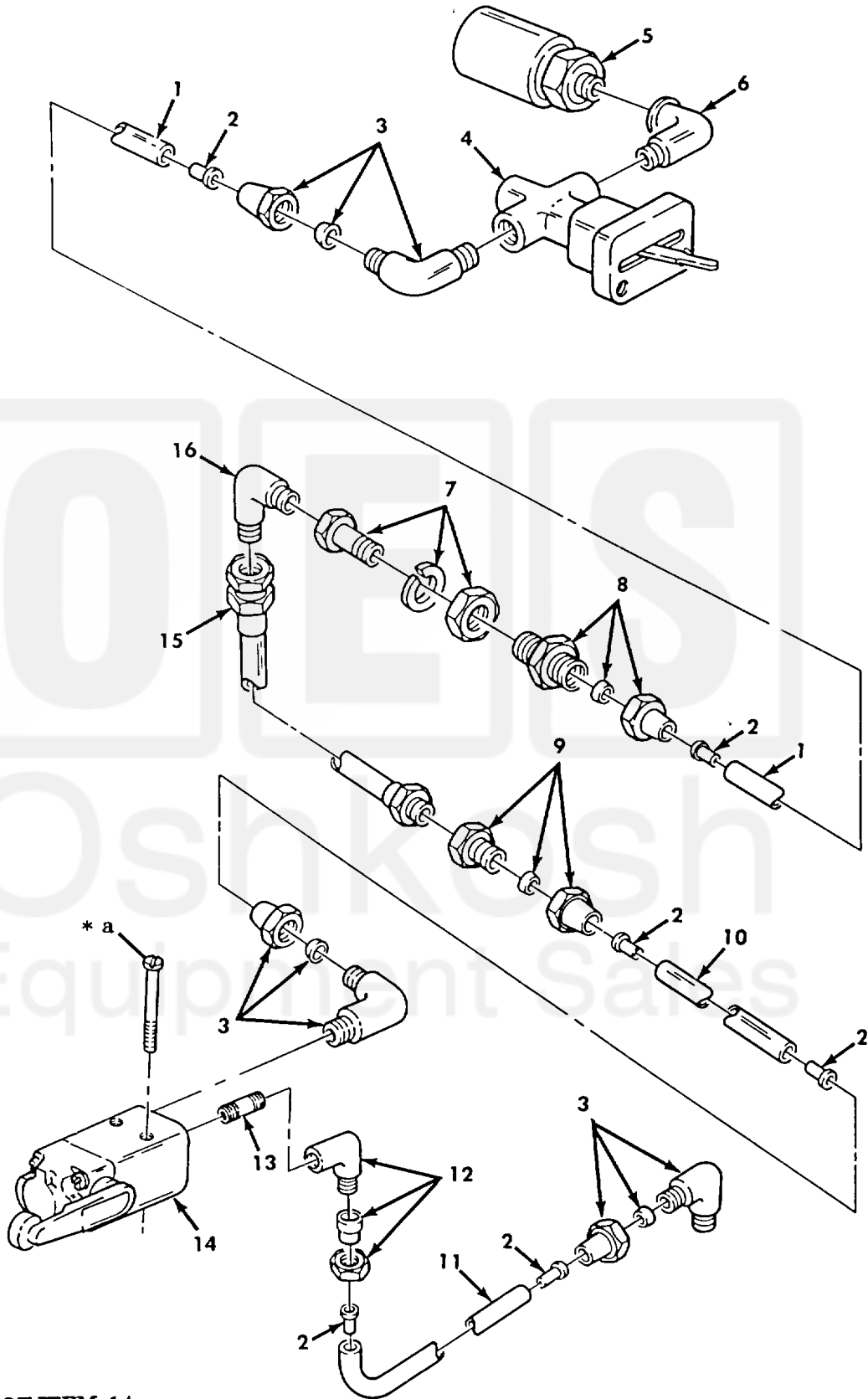

\* a PART OF ITEM 14

Figure 212. Transfer Air Control Lines.

SECTION II

TM 9-2320-272-24P-1

(1) ITEM NO	(2) SMR CODE	(3) NSN	(4) CAGEC	(5) PART NUMBER	(6) DESCRIPTION AND USABLE ON CODES (UOC)	(7) QTY
-------------------	--------------------	------------	--------------	-----------------------	--	------------

GROUP 0803 GEAR SHIFT CONTROLS

FIG. 212 TRANSFER AIR CONTROL  
LINES

1	MOOZZ		19207	CPR104420-2-18	HOSE NONMETALLIC MAKE FROM HOSE, ..... P/N CPR104420-2, 18 INCHES LONG .....	1
2	PAOZZ	4730010798821	19207	CPR102321-1	INSERT, TUBE FITTING .....	6
3	PAOZZ	4730002871604	81343	6-2 120202BA	ELBOW, PIPE TO TUBE .....	3
4	PAOZZ	4820008328077	19207	10924753	VALVE, LINEAR, DIRECT .....	1
5	PAOZA	5930004539367	19207	11609301	SWITCH, PRESSURE .....	1
6	PAOZZ	4730000530266	96906	MS51952-1	ELBOW, PIPE .....	1
7	PAOZZ	4730002786318	19207	8328782	COUPLING, PIPE. ....	1
8	PAOZZ	4730000691186	81343	6-4 120102BA	ADAPTER, STRAIGHT, PI .....	1
9	PAOZZ	4730002778770	81343	6-6 120103BA	ADAPTER, STRAIGHT, PI .....	1
10	MOOZZ		19207	CPR104420-2-45	HOSE NONMETALLIC MAKE FROM HOSE, ..... P/N CPR104420-2, 45 INCHES LONG .....	1
11	MOOZZ		19207	CPR104420-2-26	HOSE NONMETALLIC MAKE FROM HOSE, ..... P/N CPR104420-2, 26 INCHES LONG .....	1
12	PAOZZ	4730002894052	81343	6-2 120203BA	ELBOW, PIPE TO TUBE .....	1
13	PAOZZ	4730001961966	96906	MS51846-13	NIPPLE, PIPE .....	1
14	PAOZZ	4820013293245	97902	LSC-3270-S26022- 1	VALVE, LINEAR, DIRECT .....	1
15	PAOZZ	4720011079939	19207	12256272	HOSE ASSEMBLY, NONME .....	1
16	PAOZZ	4730008127999	96906	MS51504A6	ELBOW, PIPE TO TUBE .....	1

END OF FIGURE

Oshkosh  
Equipment Sales